

# KLM168 LED AMBER 5VDC-32VDC NVIS

## Technical Data Sheet



Kuerzi Aviation AG  
Flugplatz  
CH-9506 Lommis

info@kuerzi.com  
www.kuerzi.com

Tel. +41 52 376 22 27

### Description

The KLM168 LED AMBER 5VDC-32VDC NVIS is a small, NVIS friendly amber LED indication light designed for aeronautical applications. It operates under a wide voltage range from 5 - 32VDC, which makes it suitable for many purposes.

The product meets aviation standards and requirements and is delivered with an EASA Form 1. The applicable approval can be provided by us specifically for your aircraft type.

### Features

- 5 - 32VDC
- Peak Wavelength: 580 nm
- 50mA
- NVIS Friendly

### Application example

The KLM168 has been installed in numerous occasions in cockpits or on medical supply panels as LED indication light.

Other LED indication lights are available and can be adapted to fit your requirements.

Product that also might interest you:

0616071.3 KLM107 NVIS LED 327

1823246-2 KLM109 LED GREEN 5VDC-32VDC NVIS

1414914.5 KLM110 LED BLUE 5VDC-32VDC NVIS

## Technical Specifications

Nominal Operating Input Current	50 mA
Min Operating Temperature	-15°C
Max Operating Temperature	+70°C
General comment	Wired cable length 25cm

## Mechanical Dimensions

Weight of the unit 6.00 Gr

Weight of the unit including required installation materials (w/o wiring) 6.00 Gr

All dimensions [mm]

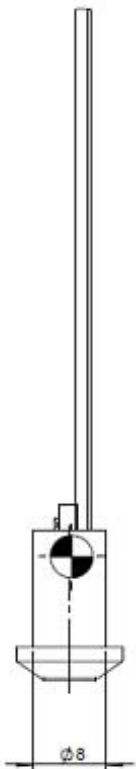
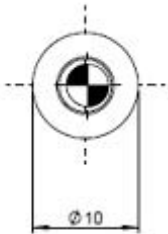

## Configuration / Ordering Data

Part Number	Type	Description
1721192-6	KLM168	LED AMBER 5VDC-32VDC NVIS

### Additional Parts for installation:

Qty	Part Number	Description
2	D-436-36	MiniSeal Spleissverbinder ROT